



## Host and Presenter Roles in Adobe Connect

The presenter role can be assigned to a user when they are enrolled or a host can promote a participant to the presenter role (\*a demoted host retains its capabilities). The host has full control over the Adobe Connect session while the presenter role is appropriate for student presentations or guest presenters - a medium level, contained role. This side by side comparison compares both roles.

Each session must have at least one host to control the session – recording, moving between layouts, opening pods, and granting capabilities to participants.

### HOST

#### Interface Differences

- hosts chooses which layout to show and pods to open

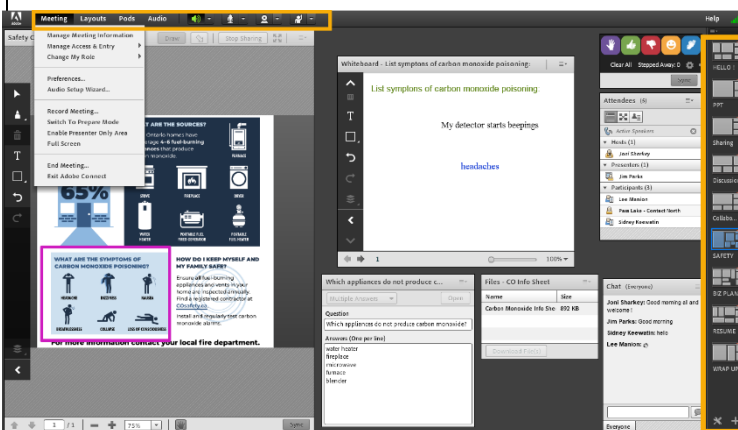

### PRESENTER

- presenters do not see layouts, cannot open nor resize nor hide pods
- presenters work with the layout and pods the host has opened / chosen

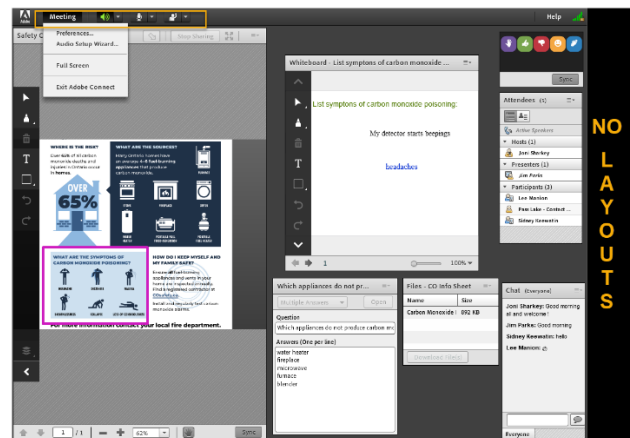

#### Menus and Initial Tools

- host has full capabilities and tools

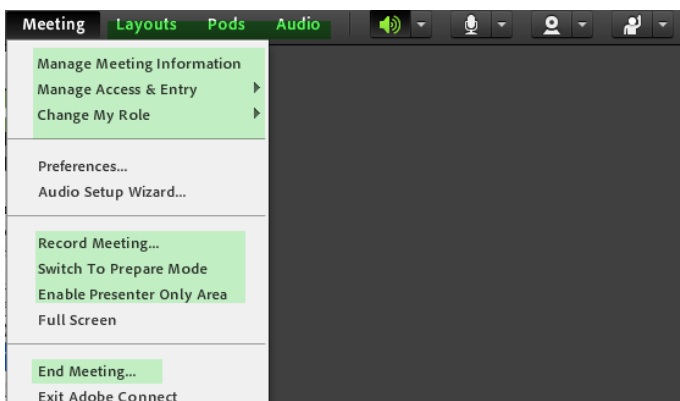

- presenter has microphone, draw, and webcam capabilities (host must open Video pod)
- presenter has fewer menu and Meeting options
- presenter does not have Record Meeting

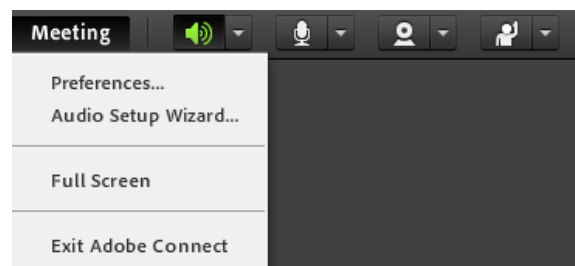

HOST	PRESENTER
<p><b>Content</b></p> <ul style="list-style-type: none"> <li>host must open the Share pod</li> </ul>	<ul style="list-style-type: none"> <li>once the host opens a Share pod, presenter can               <ul style="list-style-type: none"> <li>screen share</li> <li>open a whiteboard (but not rename title bar)</li> <li>upload their own content AND <i>Recently Shared</i> content AND upload content from <i>Share History, Whiteboards, Uploaded Files, Extra Pods</i></li> <li><i>Sync / Unsync</i> Share pod content</li> </ul> </li> </ul>

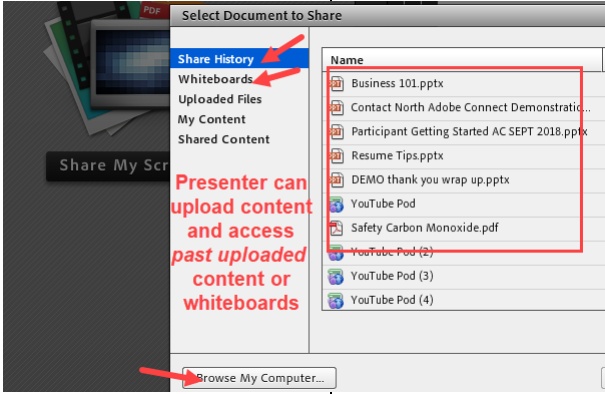

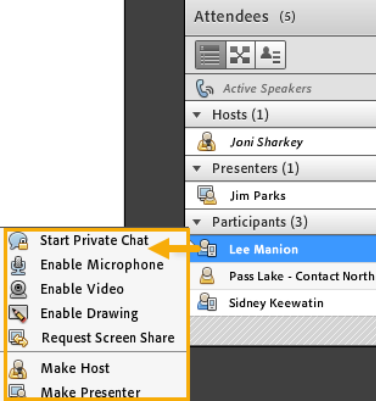
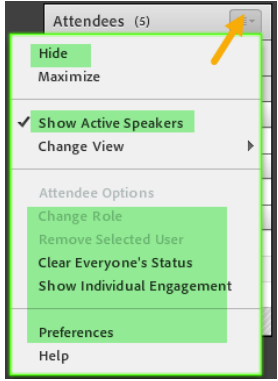
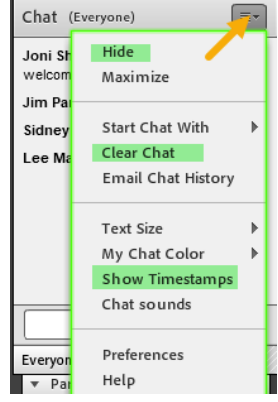
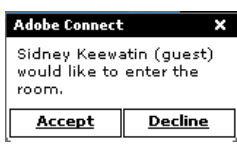
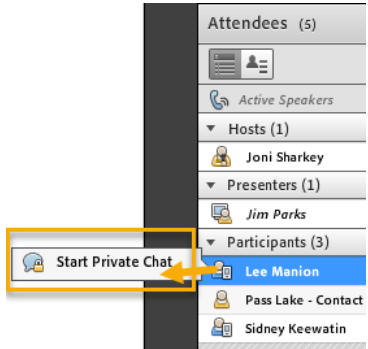
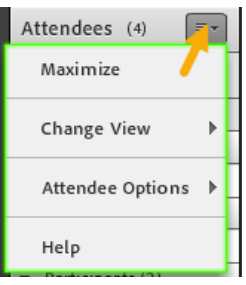
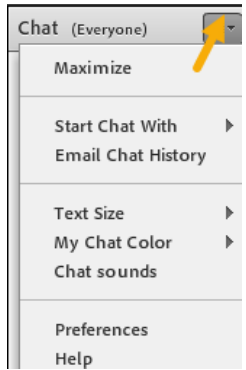
<p><b>Interacting With Participants</b></p> <ul style="list-style-type: none"> <li>only hosts see a guest attend request</li> </ul>    	<ul style="list-style-type: none"> <li>presenter only (host not in the session) allows enrolled participants into the session</li> <li>presenters <b>do not see guest attend request</b></li> <li>presenter <b>cannot give participants microphones, webcam, nor individual drawing tools</b> however can access some <i>Preferences</i> and <i>Enable Participants to Draw</i></li> <li>presenter <b>cannot change participants' role, clear status, or clear Chat</b></li> </ul>   
--	---

For additional Adobe Connection resources please visit [eclassesconnect.contactnorth.ca/help](http://eclassesconnect.contactnorth.ca/help)

1-888-850-4628 Contact North Helpdesk, Monday to Friday, 7:30am ET to 10:30pm ET